

PART NUMBER	REV	FIRST USED
466975-1	F	463345-1

TERMINAL NAME:		VISIBLE PAD LTR		CRIMPING DATA	
SIZE	20DE	AMPLIMITE	CONTACT	CRIMP HEIGHT	WIRE SIZE
	PIN	748333	SOCKET	748610	
A		.027±.001			26
B		.025±.001			28
C		.034±.001			22
D		.030±.001			24
CRIMP	SIZE	TYPE	RANGE		
WIRE	.042	F	28-22		
INSUL	.048	0	.030-.040		
FEED	APPL INST	SET UP GAGE	LAYOUT		
.220 .217	A1	-	621A		
TERM	APPL	SPEC	WIRE STRIP LENGTH		
			-		

SIM TO HDM 567243

THIS DRAWING IS A CONTROLLED DOCUMENT FOR AMP INCORPORATED. IT IS SUBJECT TO CHANGE AND THE CONTROLLING ENGINEERING ORGANIZATION SHOULD BE CONTACTED FOR THE LATEST REVISION.

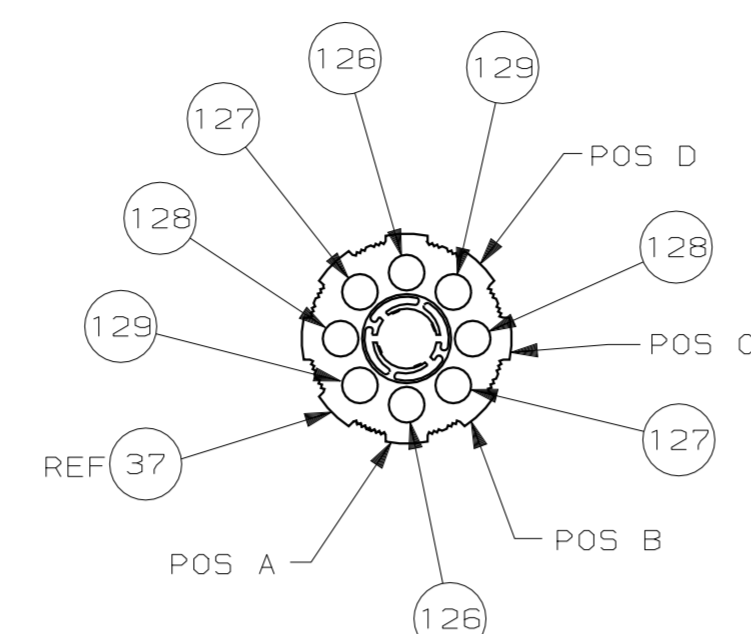
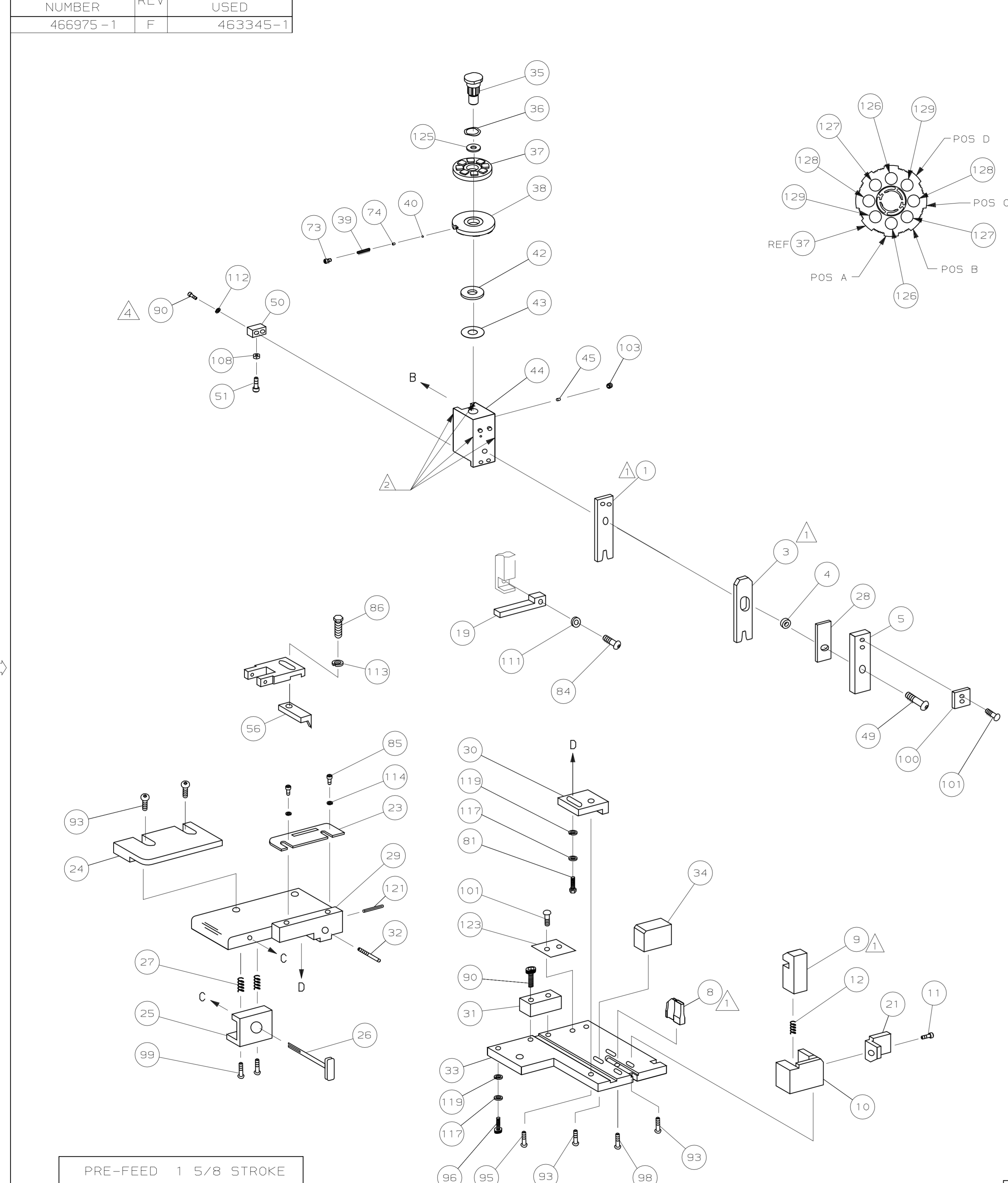

QTY	REV	DESCRIPTION	PART NO	ITEM NO	
2	-	C	7-354779-2	PIN, WIRE DISC (.3350)D	129
2	-	C	6-354779-8	PIN, WIRE DISC (.3330)C	128
2	-	C	6-354779-2	PIN, WIRE DISC (.3300)B	127
2	-	C	5-354779-4	PIN, WIRE DISC (.3260)A	126
1	-	A	986950-1	WASHER, FLAT PRECISION	125
					124
1	-	B	690701-2	PLATE, SERIAL NO.	123
					122
1	-	A	4-21028-0	PIN,SLT SPR(Ø.093x.75)ST GDE PL	121
					120
2	-	A	21899-2	WASHER,FLAT(#10)S G ADJ BLK	119
					118
2	-	A	21024-5	WASHER, LOCK(#10)ADJ BLOCK	117
					116
					115
2	-	A	21024-2	WASHER,LOCK(#4)FRONT STP GUIDE	114
REF	-	A	21024-4	WASHER,LOCK(#8)FEED FINGER	113
2	-	A	21024-4	WASHER,LOCK(#8)DEP-HOLD	112
REF	-	A	21024-4	WASHER,LOCK(#8)STRIPPER	111
					110
					109
1	-	A	21018-5	NUT, HEX(#6)HOLD DOWN	108
					107
					106
					105
1	-	A	21009-2	SCR,SKT SET(1/4-20x.25 LW)RAM	104
					103
					102
4	-	A	21017-2	SCR,DRIVE(#2x.19)ID PLATE	101
1	-	B	819347-1	PLATE, IDENTIFICATION	100
2	-	A	3-21002-0	SCR,BHC (10-32X.88)DRAG	99
1	-	A	22733-8	SCR,BHC(8-32x.38 LW)ANVIL	98
					97
1	-	A	3-21000-8	SCR,SHC(10-32x.88)MOUNTING	96
1	-	A	2-21002-7	SCR, BHC(10-32x.50) SG ADJ BLK	95
					94
6	-	A	2-21002-2	SCR,BHC(8-32x.50)R STP GDE	93
					92
1	-	A	1-21002-7	SCR,SHC(6-32x.50)CAM	91
4	-	A	2-21000-7	SCR,SHC(8-32x.50)SCR BLK	90
					89
					88
					87
REF	-	A	2-22603-0	SCR,HEX HD(8-32x.31)FEED FINGER	86
2	-	A	1-21000-3	SCR,SHC(4-40x.25)F ST GUIDE	85
REF	-	A	2-21002-1	SCR,BHC(8-32X.38)STRIPPER	84
					83
					82
1	-	A	3-22603-1	SCR HEX HD (10-32x.38) SG ADJ BLK	81
					80
					79
					78
2	-	B	463310-8	BLADE, STRIPPING (#26)	77
					76
					75
1	-	A	690603-1	SPRING, ASSIST	74
1	-	A	23030-1	SCR,SKT CAP(6-32x.25)CP DSC	73
					72
					71

QTY	REV	DESCRIPTION	PART NO	ITEM NO	
				70	
				69	
				68	
				67	
				66	
				65	
				64	
				63	
				62	
				61	
				60	
				59	
				58	
				57	
REF	-	B	694433-8	PAWL, FEED	56
					55
					54
					53
					52
1	-	A	811242-2	BUMPER, HOLDDOWN	51
1	-	A	690753-1	SPACER, TONKER	50
1	-	A	7-21002-9	BOLT, CRIMPER(5/16x1.00)	49
1	-	A	690602-6	CAM, PRE-FEED 1.62 STROKE	48
					47
					46
1	-	A	690191-1	PLUG, NYLON	45
1	-	C	455673-1	RAM	44
1	-	A	690125-1	WASHER, LAMINATED	43
1	-	A	690124-1	WASHER, RAM	42
					41
1	-	A	23241-6	BALL, STEEL	40
1	-	A	690170-1	SPRING, COMPRESSION	39
1	-	C	690142-4	DISC, INSULATION	38
1	-	D	354777-1	WIRE DISC, PLASTIC	37
1	-	A	22480-5	WASHER, SPRING	36
1	-	B	690212-1	POST, RAM	35
1	-	B	692776-2	SUPPORT, TERMINAL	34
1	-	C	462544-1	PLATE, BASE SPECIAL	33
1	-	A	690432-3	SCREW, ADJUSTMENT	32
1	-	B	462543-1	BLOCK, SCREW SPECIAL	31
1	-	B	455689-1	BLOCK, STRIP GUIDE ADJ	30
1	-	C	455671-8	PLATE, STRIP GUIDE	29
1	-	C	1-455888-0	SPACER, FRONT SHEAR DEP	28
2	-	A	1-22284-0	SPRING, DRAG	27
1	-	B	690546-1	LEVER, DRAG RELEASE	26
1	-	B	240792-1	DRAG, TERMINAL	25
1	-	D	6-690504-4	GUIDE, STRIP (REAR)	24
1	-	A	690438-1	GUIDE, STRIP (FRONT)	23
					22
1	-	A	463756-1	GUIDE, SCRAP	21
					20
REF	-	C	462615-1	STRIPPER	19
					18
					17
					16
					15
					14
					13
1	-	A	5-22280-0	SPRING, SHEAR	12
1	-	B	690461-2	STOP, SHEAR (FRONT)	11
1	-	B	462548-1	HOLDER, SHEAR (FRONT) SP	10
1	-	B	462547-1	SHEAR, FLOAT (FRONT) SP	9
1	-	C	5-803653-5	ANVIL	8
					7
					6
1	-	A	462838-1	DEPRESSOR, SHEAR (FRONT) SP	5
1	-	B	238011-7	SPACER, BLOCK CRIMPER	4
1	-	C	2-683454-5	CRIMPER, INSULATION	3
					2
1	-	C	1-456401-6	CRIMPER, WIRE	1

1 RECOMMENDED SPARE PARTS.
 2 GREASE LIGHTLY.
 3 ITEM NOT SHOWN
 4 CUT TO .46 LENGTH AT ASSEMBLY.
 5 FEED ADJUSTMENT REQUIRED WHEN SWITCHING FROM PIN TO SOCKET AND VICE VERSA.

PRE-FEED 1 5/8 STROKE
 (REF)
 ROTATED 180°
 B

QTY	REV	DESCRIPTION	PART NO	ITEM NO	
-1	U/M	DWG SIZE	PART NO	DESCRIPTION	ITEM NO
REVISION OF EACH ASSY NO (WHEN BLANK, USE DWG REVISION)					
QTY RECD PER ASSY			PARTS LIST		

QTY	REV	DESCRIPTION	PART NO	ITEM NO	
-1	U/M	DWG SIZE	PART NO	DESCRIPTION	ITEM NO
REVISION OF EACH ASSY NO (WHEN BLANK, USE DWG REVISION)					
QTY RECD PER ASSY			PARTS LIST		

MATL - HT TR - FIN -
 DIMENSIONS IN INCHES. DO NOT SCALE PRINT.
 TOLERANCES UNLESS OTHERWISE SPECIFIED:
 2 PLC DEC ±
 3 PLC DEC ±
 4 PLC DEC ±
 ANGLES ± -
 SURF TEXTURE: ✓
 REMOVE BURRS, BREAK SHARP EDGES R.015 MAX

DR 9/9/93 APP 10-5-93
 D.SALTZER E.KOOTTE
 CHK 10-5-93 REL 11/11/93
 C.ERISMAN G. OCHENIS

AMP Incorporated
 Harrisburg, PA 17105-3608

NAME STRIPPER CRIMPER APPLICATOR MACHINE REF STRIPPER CRIMPER
 SCALE - DWG NO 466975 SHEET 1 OF 1 REV F