

REV.	DATE	DESCRIPTION
NC	01/02/07	INITIAL RELEASE

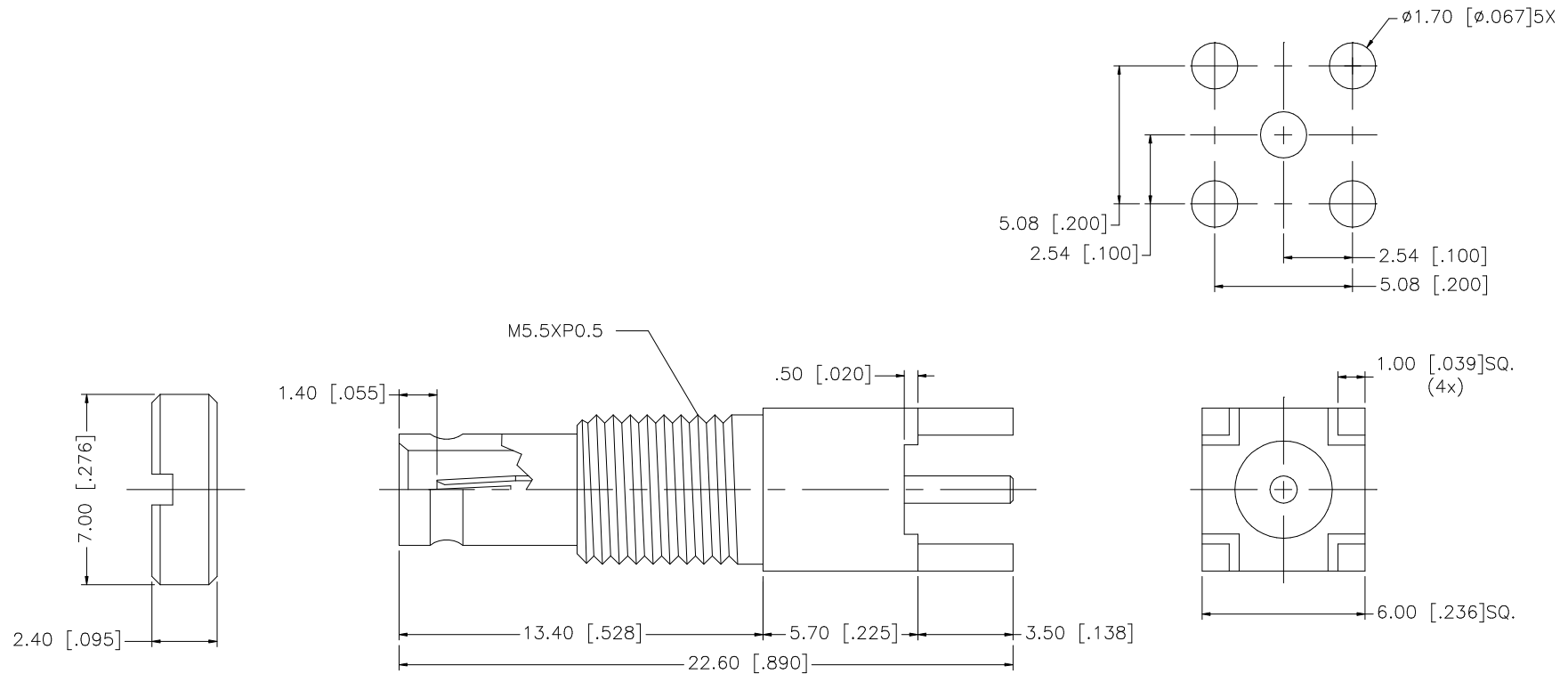

8				<small>UNLESS OTHERWISE SPECIFIED DIMENSIONS ARE IN MILLIMETERS. DIMENSIONS IN [] ARE IN INCHES AND FOR CUSTOMER REFERENCE ONLY.</small> <small>UNLESS OTHERWISE SPECIFIED TOLERANCES FOR MILLIMETERS ARE:</small> 0.5 - 8mm \pm 0.20mm 8 - 30mm \pm 0.40mm 30 - 120mm \pm 0.50mm <small>UNLESS OTHERWISE SPECIFIED TOLERANCES FOR INCHES ARE:</small> .020 - .315 \pm 0.007" .315 - 1.180 \pm 0.015" 1.180 - 4.724 \pm 0.020"	APPROVALS	DATE	<h1 style="color: blue;">Amphenol Connex</h1>	
7			DRAWN		G.R.S.	01/02/07		PART DESCRIPTION 1.0/2.3 PCB BULKHEAD RECEPTACLE - 75ohm
6			CHECKED					
5			ISSUED					
4	SPANNER NUT	BRASS	NICKEL		1			
3	CONTACT PIN	BER. COPPER	GOLD	1			PART NO. 282121-75	
2	INSULATOR	TEFLON	NATURAL	1				
1	BODY	BRASS	GOLD	1			DWG. NO. 282121-75.DWG REV. A SIZE A SCALE NA	
	DESCRIPTION	MATERIAL	FINISH	QTY	DO NOT SCALE DRAWING	C:/282/282121-75.DWG		