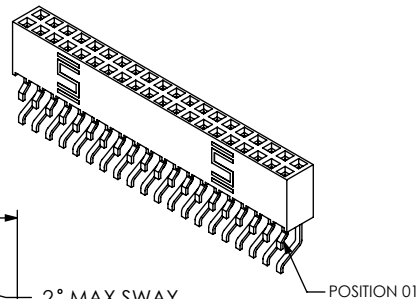

TABLE 1	
LEAD STYLE	CONTACT
-02	C-8-03-XXX
-22	C-17-03-XXX



SMH-1XX-XX-XX-X-XX

NO. OF POSITIONS
-02 THRU -36
(PER ROW)

LEAD STYLE
-02: SURFACE MOUNT
(USE C-8-03-X)
-22: LOW INSERTION FORCE
(USE C-17-03-X)

OPTIONS
-XX: INDICATES POSITION
POLARIZED (USE PK-06-N)
-TR: TAPE & REEL PACKAGING
(2 - 29 POSITIONS ONLY)

ROW SPECIFICATION
-D: DOUBLE ROW (USE SMH-50-D)
(SEE FIG 1)
-S: SINGLE ROW (USE SSW-50-S)
(SEE FIG 2, SHT 2)

PLATING
-G: 20μ" OVER IN CONTACT AREA, FLASH GOLD ON TAIL
-T: TIN OVER, MATTE TIN ON TAIL
-S: 30μ" OVER IN CONTACT AREA, MATTE TIN ON TAIL
-F: 3μ" OVER IN CONTACT AREA, MATTE TIN ON TAIL
-H: 30μ" OVER IN CONTACT AREA, FLASH GOLD ON TAIL
-L: 10μ" OVER IN CONTACT AREA, MATTE TIN ON TAIL
-TM: TIN OVER, MATTE TIN ON TAIL
-SM: 30μ" OVER IN CONTACT AREA, MATTE TIN ON TAIL
-FM: 3μ" OVER IN CONTACT AREA, MATTE TIN ON TAIL

DO NOT
SCALE FROM
THIS PRINT

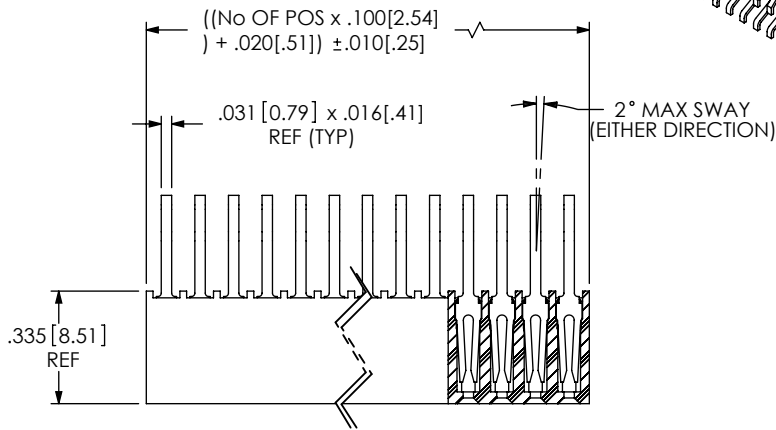

SECTION "A"- "A"

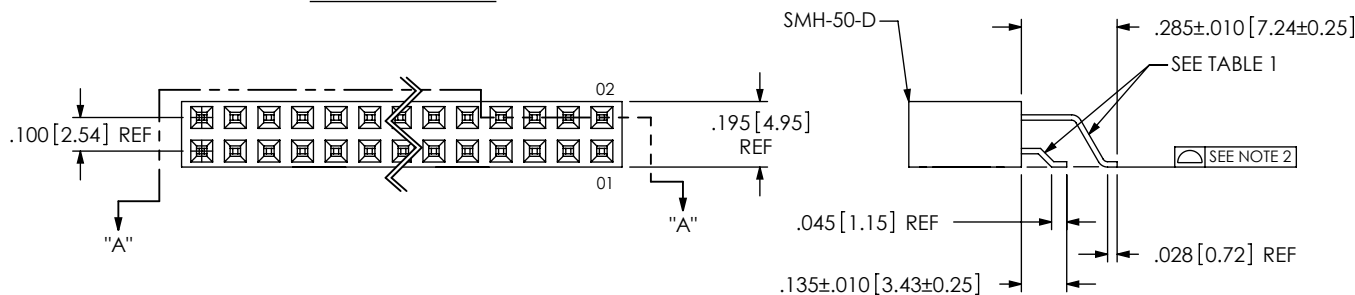

FIG 1
SMH-120-XX-XX-D SHOWN
SEE SHEET 2 FOR IN-PROCESS VIEWS

NOTES:

1. C REPRESENTS A CRITICAL DIMENSION.
2. COPLANARITY: POSITIONS 02-24= .006[.15], POSITIONS 25-36= .008[.20].
3. BURR ALLOWANCE: .003[.08] MAX.
4. ONE POSITION WILL BE LOST FOR EVERY CUT MADE ON A SOCKET STRIP: CUT FLASH TO BE .010 [25] MAX WITH NO FLASH ALLOWED IN HOLES OR EXTENDING BELOW LEADS
5. MINIMUM PUSHOUT FORCE: 1.5 LB.
6. MAXIMUM ALLOWABLE BOW: .003[.08] INCH/INCH AFTER ASSEMBLY.
7. ENDWALLS AFTER CUTTING: .045 +/- .003.
8. SHEAR TAILS TO DIMENSION SHOWN.
9. CONTACT TAILS TO BE FLUSH TO .003[.08] ABOVE OR BELOW A DATUM LINE (MADE BY THE INSULATOR. (-DH ONLY)
10. NOTE DELETED.
11. POSITIONS 4 OR LESS SHOULD BE LAYER PACKAGED UNLESS OTHERWISE NOTED IN THE PART CALLOUT.
12. NOTE DELETED.

UNLESS OTHERWISE SPECIFIED,
DIMENSIONS ARE IN INCHES.
TOLERANCES ARE:
DECIMALS ANGLES
.XX: ±.01 [.3] 2°
.XXX: ±.005 [.13]
.XXXX: ±.0020 [.051]

PROPRIETARY NOTE
THIS DOCUMENT CONTAINS INFORMATION
CONFIDENTIAL AND PROPRIETARY TO
SAMTEC, INC. AND SHALL NOT BE REPRODUCED
OR TRANSFERRED TO OTHER DOCUMENTS OR
DISCLOSED TO OTHERS OR USED FOR ANY
PURPOSE OTHER THAN THAT WHICH IT WAS
OBTAINED WITHOUT THE EXPRESSED WRITTEN
CONSENT OF SAMTEC, INC.



520 PARK EAST BLVD., NEW ALBANY, IN 47150
PHONE: 812-944-6733 FAX: 812-948-5047
e-Mail: info@SAMTEC.com code: 55322

MATERIAL: DO NOT SCALE DRAWING SHEET SCALE: 2:1
INSULATOR: LCP, UL 94 VO, COLOR: BLACK
CONTACT: PHOSPHOR BRONZE

DESCRIPTION:
.100 [2.54] HORIZONTAL SMT SOCKET ASSEMBLY

DWG. NO. SMH-1XX-XX-XX-X-XX

BY: BRATCHER 2/5/99 SHEET 1 OF 3

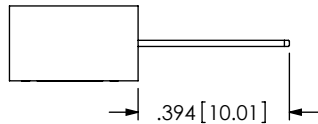

IN-PROCESS 1

MUST FILL WITH DIE SIDE OF PIN FACING DOWN, PINS ARE STAMPED WITH A SQUARE INDICATOR MARK ON DIE SIDE

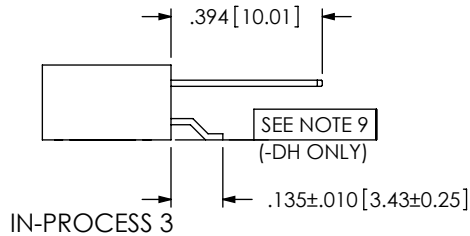

IN-PROCESS 3

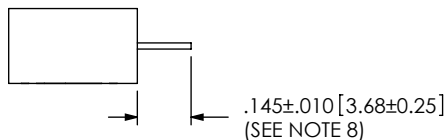
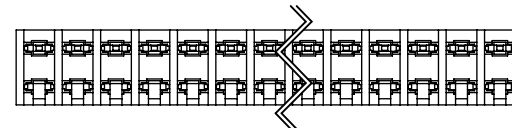

IN-PROCESS 2

MUST FILL WITH DIE SIDE OF PIN FACING DOWN, PINS ARE STAMPED WITH A SQUARE INDICATOR MARK ON DIE SIDE

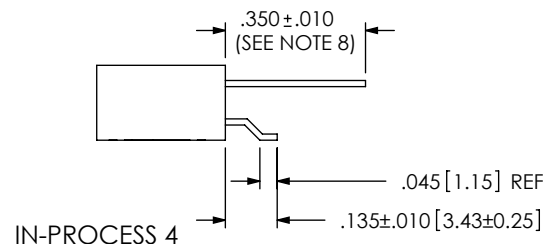

IN-PROCESS 4

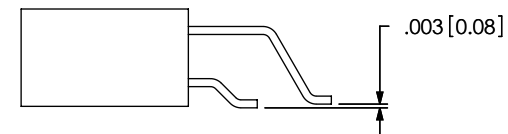
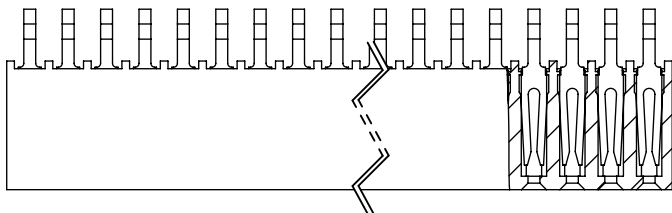

IN-PROCESS 5
TAILS MUST BE WITHIN +/- .003 WITH RESPECT TO EACH OTHER.

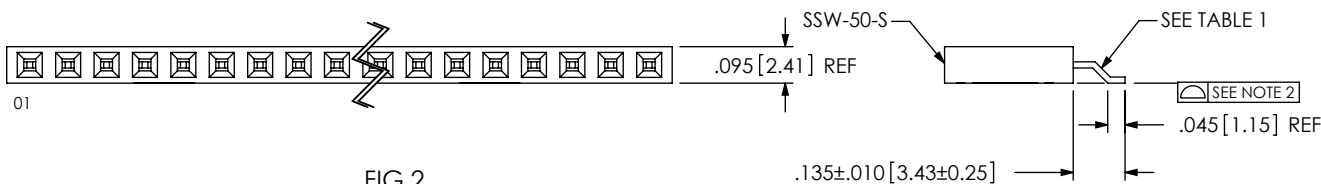
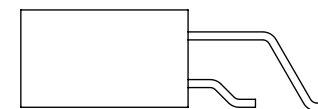
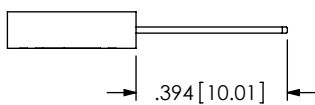
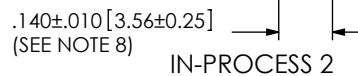

FIG 2
SMH-120-XX-XX-S SHOWN
(SAME AS FIG 1, UNLESS OTHERWISE STATED)

F:\DWG\MISC\MKTG\SMH-1XX-XX-XX-X-XX-MKT.SLDDRW



IN-PROCESS 1



IN-PROCESS 2

CPC FREQUENCY THIS SHEET	
A	
B	C9
C	
D	

PROPRIETARY NOTE
THIS DOCUMENT CONTAINS INFORMATION CONFIDENTIAL AND PROPRIETARY TO SAMTEC, INC. AND SHALL NOT BE REPRODUCED OR TRANSFERRED TO OTHER DOCUMENTS OR DISCLOSED TO OTHERS OR USED FOR ANY PURPOSE OTHER THAN THAT WHICH IT WAS OBTAINED WITHOUT THE EXPRESSED WRITTEN CONSENT OF SAMTEC, INC.

DO NOT SCALE DRAWING

SHEET SCALE: 2:1

samtec

520 PARK EAST BLVD, NEW ALBANY, IN 47150
PHONE: 812-944-6733 FAX: 812-948-5047
e-Mail: info@SAMTEC.com code: 55322

DESCRIPTION:
.100 [2.54] HORIZONTAL SMT SOCKET ASSEMBLY

DWG. NO.
SMH-1XX-XX-XX-X-XX

BY: BRATCHER 2/5/99 SHEET 2 OF 3

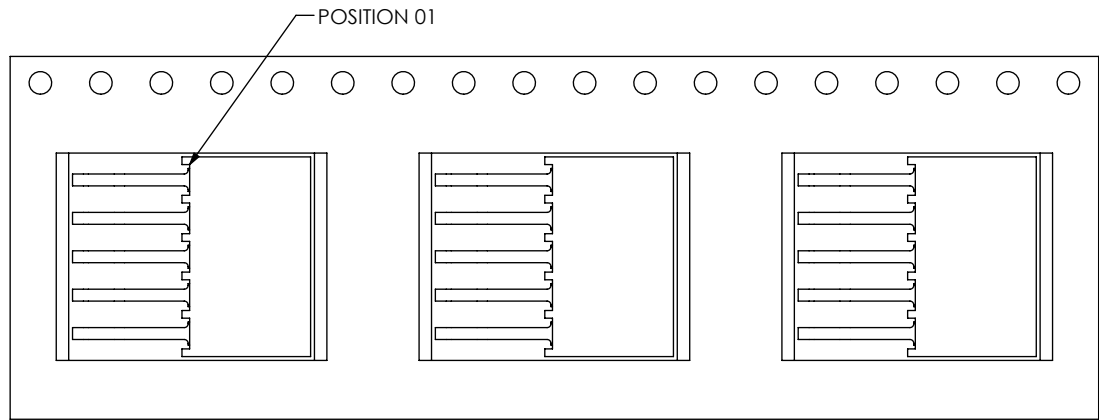

USER DIRECTION OF REELING →
POCKET NOT DETAILED

-TR PACKAGING VIEW

ALL POCKETS DESIGNED PRIOR TO REVISION T, PART ORIENTATION SHOULD FOLLOW EXISTING POCKET DESIGN.
AFTER REVISION T, ALL POCKETS ARE TO FOLLOW STANDARD ORIENTATION:
PIN #1 CLOSEST TO THE ROUND SPROCKET HOLES.

TUBE PACKAGING

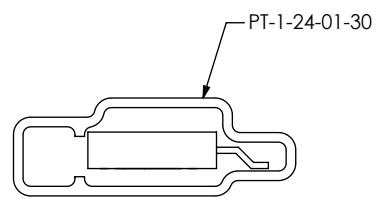
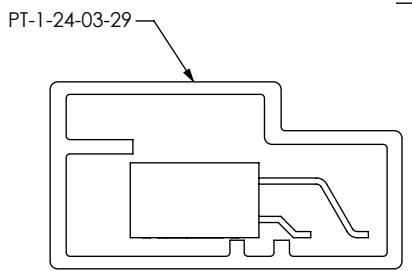

SEE NOTE 11

TABLE 2		
ROW	TUBE	PLUG
-S	PT-1-24-01-30	TP-07
-D	PT-1-24-03-29	TP-07

CPC FREQUENCY THIS SHEET	
A	
B	
C	
D	

PROPRIETARY NOTE
THIS DOCUMENT CONTAINS INFORMATION CONFIDENTIAL AND PROPRIETARY TO SAMTEC, INC. AND SHALL NOT BE REPRODUCED OR TRANSFERRED TO OTHER DOCUMENTS OR DISCLOSED TO OTHERS OR USED FOR ANY PURPOSE OTHER THAN THAT WHICH IT WAS OBTAINED WITHOUT THE EXPRESSED WRITTEN CONSENT OF SAMTEC, INC.

DO NOT SCALE DRAWING

SHEET SCALE: 2:1



520 PARK EAST BLVD., NEW ALBANY, IN 47150
PHONE: 812-944-6733 FAX: 812-948-5047
e-Mail: info@SAMTEC.com code: 55322

DESCRIPTION: .100 [2.54] HORIZONTAL SMT SOCKET ASSEMBLY	
DWG. NO. SMH-1XX-XX-XX-X-XX	
BY: BRATCHER 2/5/99	SHEET 3 OF 3