

PRODUCT NUMBER	PITCH
Klxx50x200J0G	5.08 mm

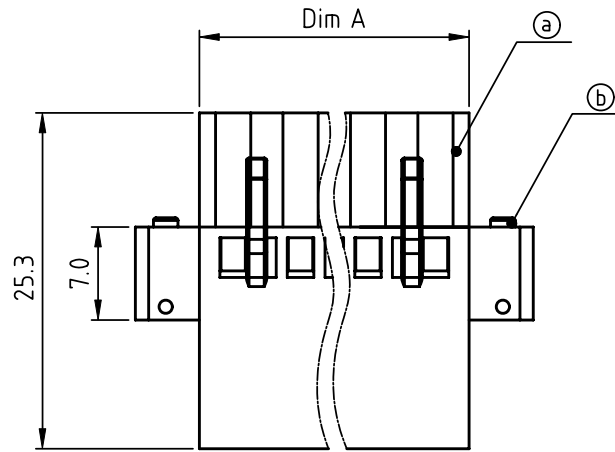
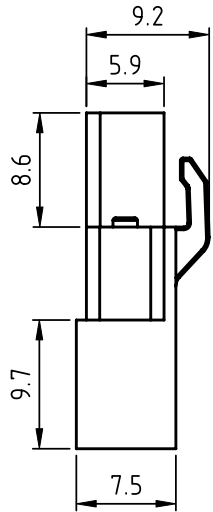
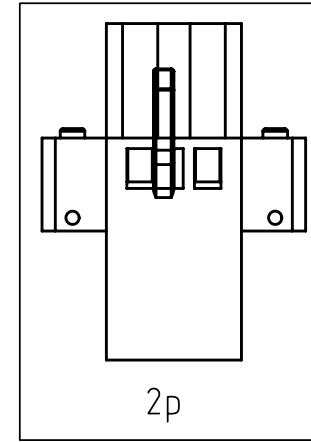
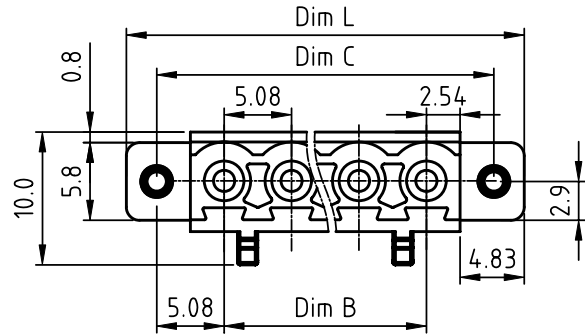

Material:

- Item (a) Terminal housing: Thermoplastic (UL94 V-0)
- Item (b) With flange screw: Steel Zinc plated, M2.5"/+/-"

Electrical cULus

- Voltage rating: 300V
- Current rating: 10A
- Wire range: 0.5-1.0mm²/1.5-2.5mm²
- Withstanding Voltage: 1.6KV
- Corresponding female crimp contacts: A0 5.08 series

N = Number of poles
 Dim L=(N-1)x5.08+14.74
 Dim A=Nx5.08
 Dim B=(N-1)x5.08
 Dim C=(N-1)x5.08+10.16

PART NO.: **KI xx 50 x 2 00J0 G**

Solid block	0	Black (RAL9005)	RoHS compliant (lead<4%)
No. of poles	2	Red (RAL3001/D)	In copper Alloy
02 2 poles	3	Orange(RAL2011/P)	
03 3 poles	4	Yellow(RAL1018/A)	
... ..	5	Green(RAL6018/T)	
24 24 poles	6	Blue (RAL5015/A)	
	8	Grey(RAL7035/D)	
	9	White(RAL1102)	
	C	Green(RAL6018/U)	

Poles	Dim L	Dim A	Dim B	Dim C
2-6p	±0.20	±0.20	±0.20	±0.20
7-12p	±0.25	±0.25	±0.25	±0.25
13-16p	±0.30	±0.30	±0.30	±0.30
17-24p	±0.40	±0.40	±0.35	±0.40

mat'l. code				surface ASME Y14.5 ✓	tolerance ASME Y14.5	projection	product family
tr				tolerances unless otherwise specified		MM	TERMINAL BLOCK
ecn	no	dr	date	angles	X.±0.5		title
				⊕	X.X±0.3	TERMINAL BLOCK	
				X*±1*	X.XX±0.1	PLUGGABLE PLUG, WITH FLANGE, CRIMP CONNECTION	
				dr	EVIN ZHONG 050414	scale	
				enr	EVIN ZHONG 050414	FCI	dwg no
				chr	HANKE FENG 050414		sheet 1 of 1
				appd	SHI JUN 050414		size
sheet index	revision sheet	A	1				Klxx50x200J0G A4
							type CUSTOMER Drawing